

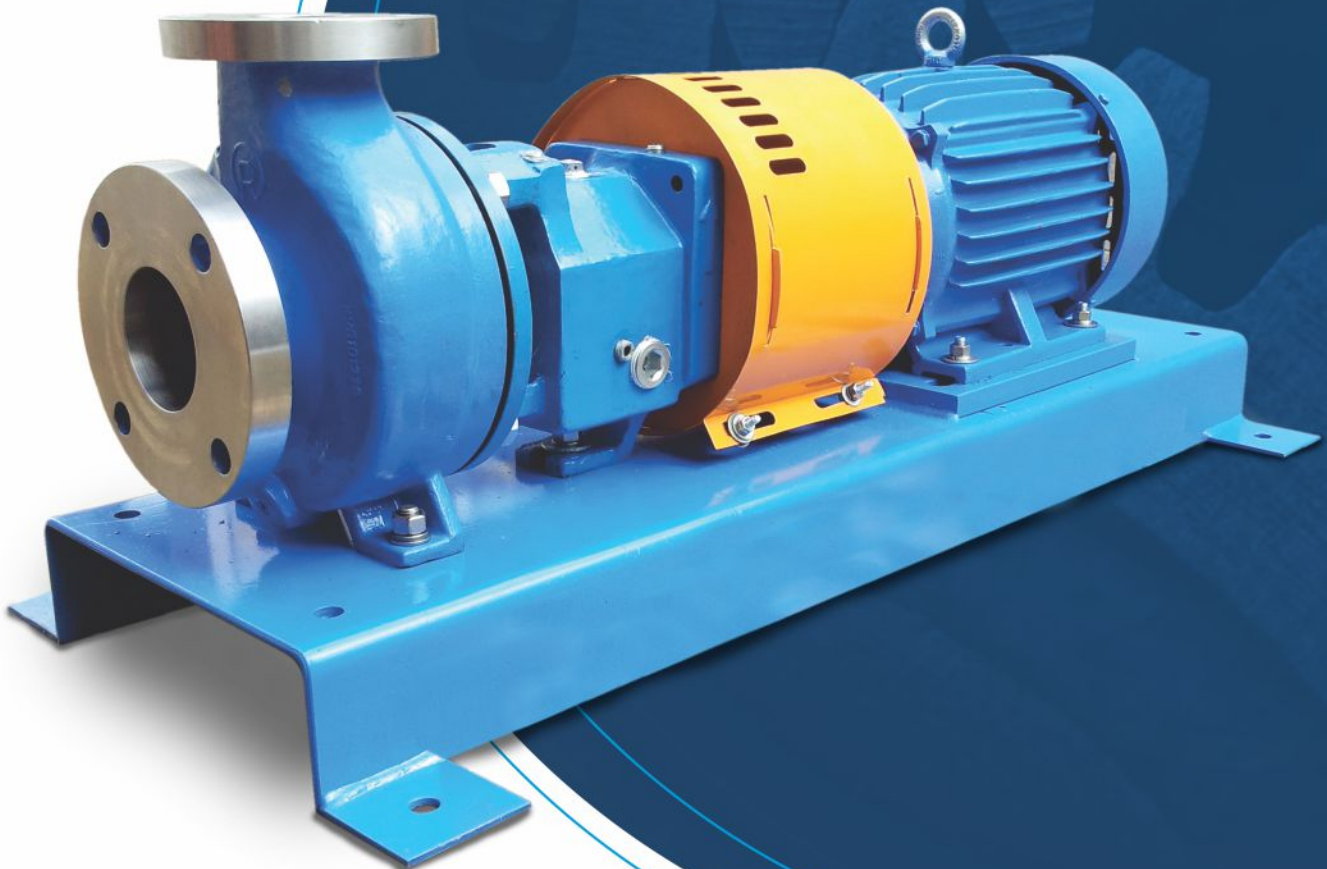

"A Trusted Partner in Pump Solutions"

ANSI CHEMICAL PROCESS PUMP

1196 SERIES



DESIGN FEATURES

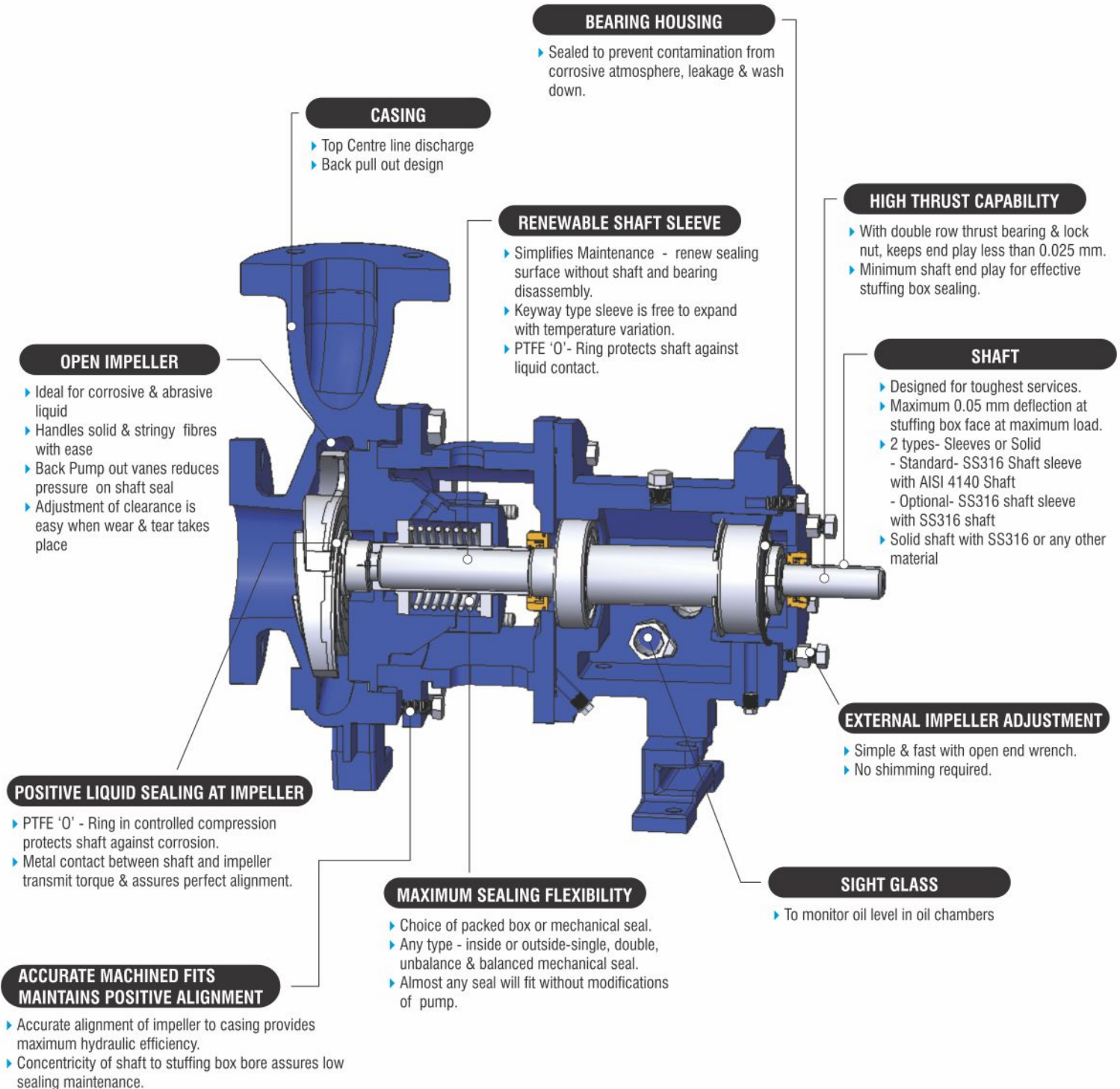

CROSS SECTION VIEW

ANSI PUMP SERIES 1196 - STR

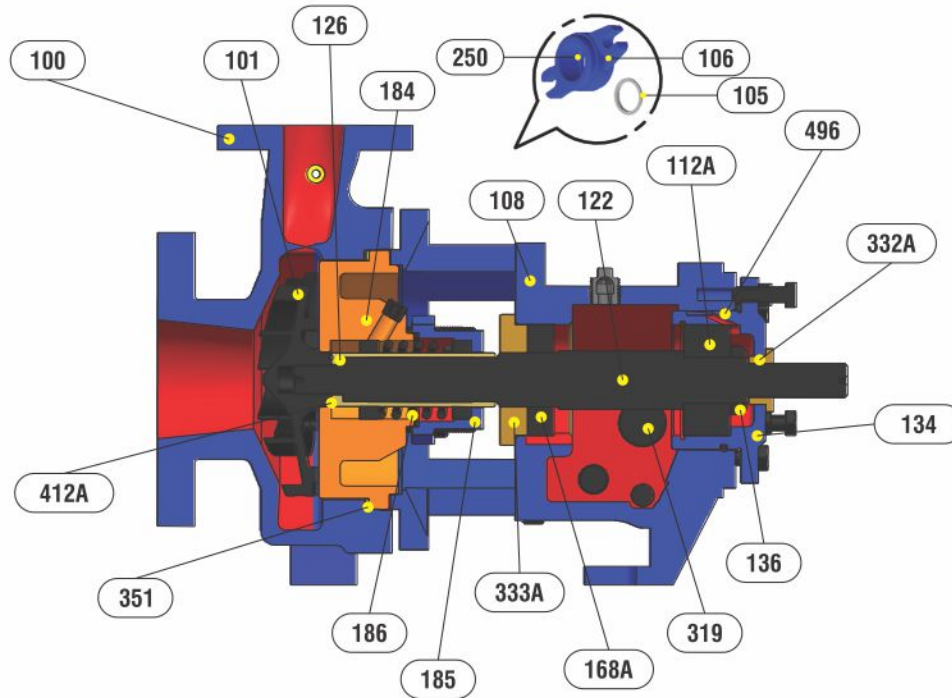

COMPONENTS LIST & MATERIAL OF CONSTRUCTION

PART NOS	PART DESCRIPTION	MATERIAL OF CONSTRUCTION					
		WCB/Carbon Steel	SS304	SS316	CD4MCu	Alloy20	Hastelloy B & C
100	Casing	WCB / Carbon Steel	SS304	SS316	CD4MCu	Alloy20	Hastelloy
101	Impeller	WCB / Carbon Steel	SS304	SS316	CD4MCu	Alloy20	Hastelloy
105	Lantern Ring (Optional)	Glass-Filled TEFLON*					
106	Stuffing Box Packing (Optional)	TEFLON* Impregnated Fibers					
108	Frame Adapter	Cast Iron / Ductile Iron					
112A	Thrust Bearing	Double Row					
122	Shaft Less Sleeve (Optional)	SS316	SS316	SS316		Alloy20	Hastelloy
122	Shaft with Sleeve	SS316	SS316	Shaftless Sleeve, Solid Shaft (Optional)			SS316
126	Shaft Sleeve	SS316		SS316	Alloy20		Hastelloy
134	Bearing Housing	Cast Iron / Ductile Iron					
136	Bearing Locknut & Lockwasher	Steel					
168	Radial Bearing	Single Row					
184	Stuffing Box Cover	WCB / Carbon Steel	SS304	SS316	CD4MCu	Alloy20	Hastelloy
185	Seal Chamber		SS304	SS316	CD4MCu	Alloy20	Hastelloy
186	Mechanical Seal	Cast Iron / Ductile Iron					
228	Bearing Frame	Not Applicable					
250	Gland (Optional)	SS316		SS316	Alloy20		Hastelloy
319	Oil Sight Glass	Glass / Aluminum					
332A	Labyrinth Oil Seal (Outboard)	Bronze					
333A	Labyrinth Oil Seal (Inboard)	Bronze					
351	Casing Gasket	Aramid Fiber with EPDM Rubber or PTFE					
370	Cap Screw, Adapter-to-Casing	Steel					
370H	Stud / Nut Cover-to-Adapter						
412A	O-Ring, Impeller	Glass-Filled TEFLON*					
418	Jacking Bolt	SS304					
496	O-Ring, Bearing Housing	Buna Rubber					

*E.I. DuPont reg. trademark

CROSS SECTION VIEW

ANSI PUMP SERIES 1196 - MTR / LTR

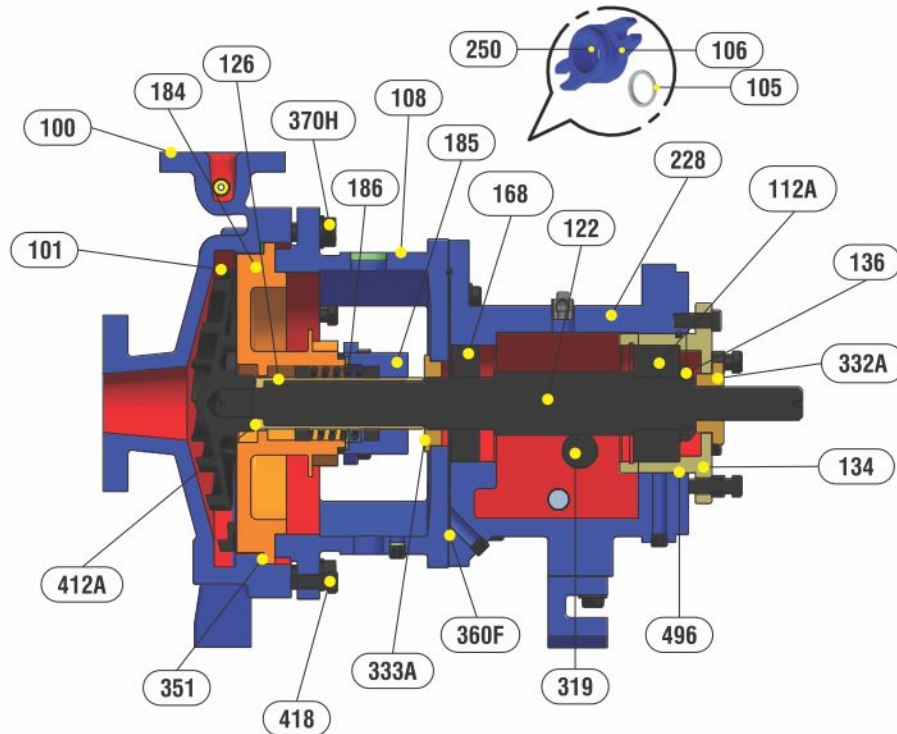

COMPONENTS LIST & MATERIAL OF CONSTRUCTION

PART NOS	PART DESCRIPTION	MATERIAL OF CONSTRUCTION					
		WCB/Carbon Steel	SS304	SS316	CD4MCu	Alloy20	Hastelloy B & C
100	Casing	WCB / Carbon Steel	SS304	SS316	CD4MCu	Alloy20	Hastelloy
101	Impeller	WCB / Carbon Steel	SS304	SS316	CD4MCu	Alloy20	Hastelloy
105	Lantern Ring (Optional)	Glass-Filled TEFLON*					
106	Stuffing Box Packing (Optional)	TEFLON* Impregnated Fibers					
108	Frame Adapter	Cast Iron / Ductile Iron					
112A	Thrust Bearing	Double Row					
122	Shaft Less Sleeve (Optional)	SS316	SS316	SS316		Alloy20	Hastelloy
122	Shaft with Sleeve	SS316	SS316	Shaftless Sleeve, Solid Shaft (Optional)			SS316
126	Shaft Sleeve	SS316		SS316	Alloy20		Hastelloy
134	Bearing Housing	Cast Iron / Ductile Iron					
136	Bearing Locknut & Lockwasher	Steel					
168	Radial Bearing	Single Row					
184	Stuffing Box Cover	WCB / Carbon Steel	SS304	SS316	CD4MCu	Alloy20	Hastelloy
185	Seal Chamber		SS304	SS316	CD4MCu	Alloy20	Hastelloy
186	Mechanical Seal						
228	Bearing Frame	Cast Iron / Ductile Iron					
250	Gland (Optional)	SS316		SS316	Alloy20		Hastelloy
319	Oil Sight Glass	Glass / Aluminum					
332A	Labyrinth Oil Seal (Outboard)	Bronze					
333A	Labyrinth Oil Seal (Inboard)	Bronze					
351	Casing Gasket	Aramid Fiber with EPDM Rubber or PTFE					
370	Cap Screw, Adapter-to-Casing	Steel					
370H	Stud / Nut Cover-to-Adapter	SS304					
412A	O-Ring, Impeller	Glass-Filled TEFLON*					
418	Jacking Bolt	SS304					
496	O-Ring, Bearing Housing	Buna Rubber					
496B	Dowel Pin, Frame-to-Adapter	Steel					

COMPONENTS / PARTS INTERCHANGEABILITY

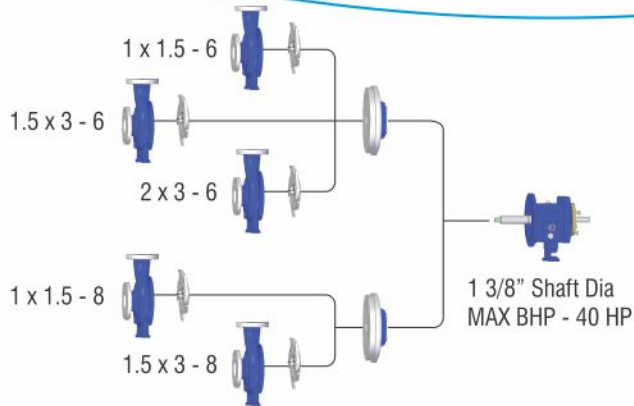

**MODEL 1196
STR**

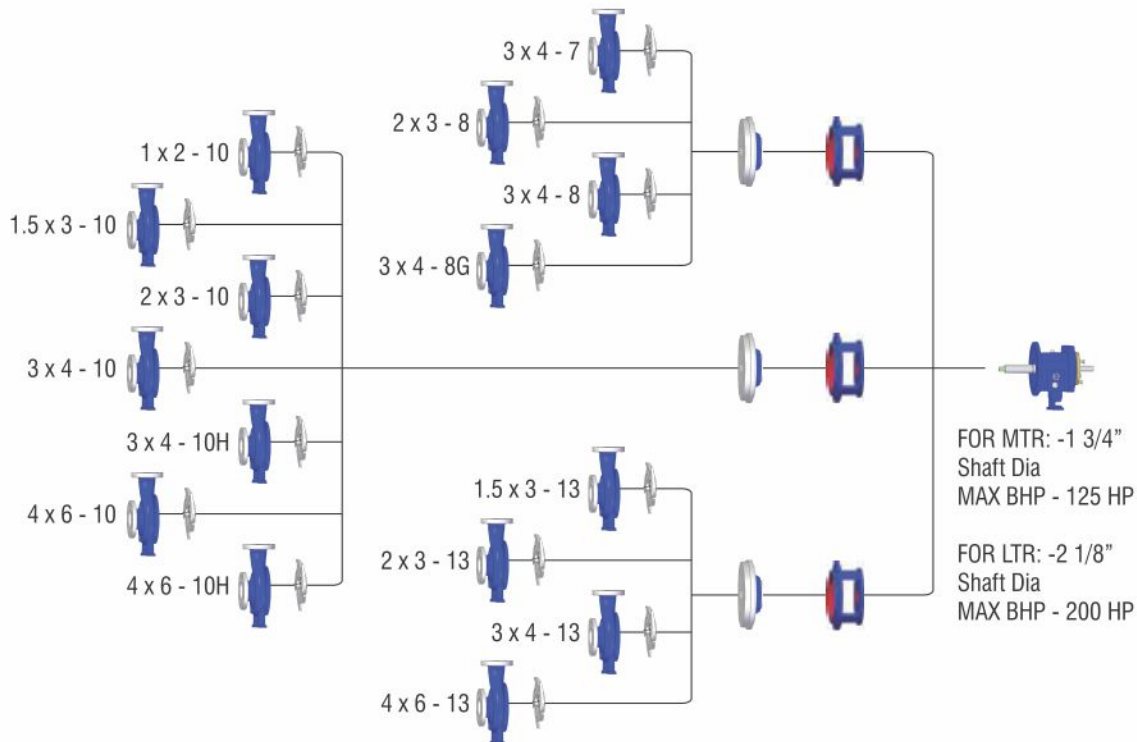

**MODEL 1196
MTR / LTR**

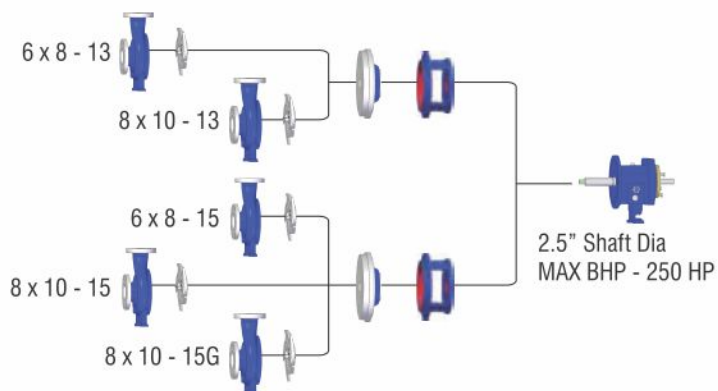

**MODEL 1196
XLR**

HYDRAULIC COVERAGE

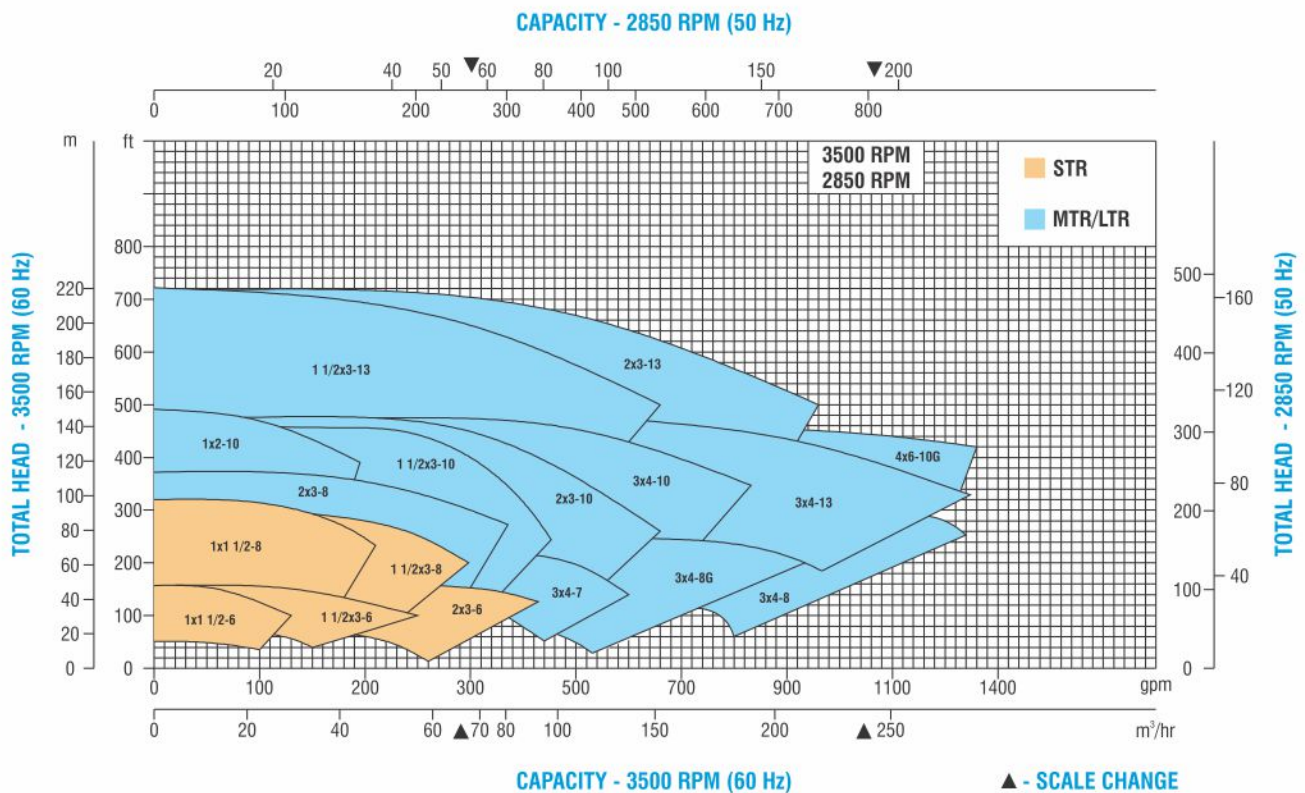
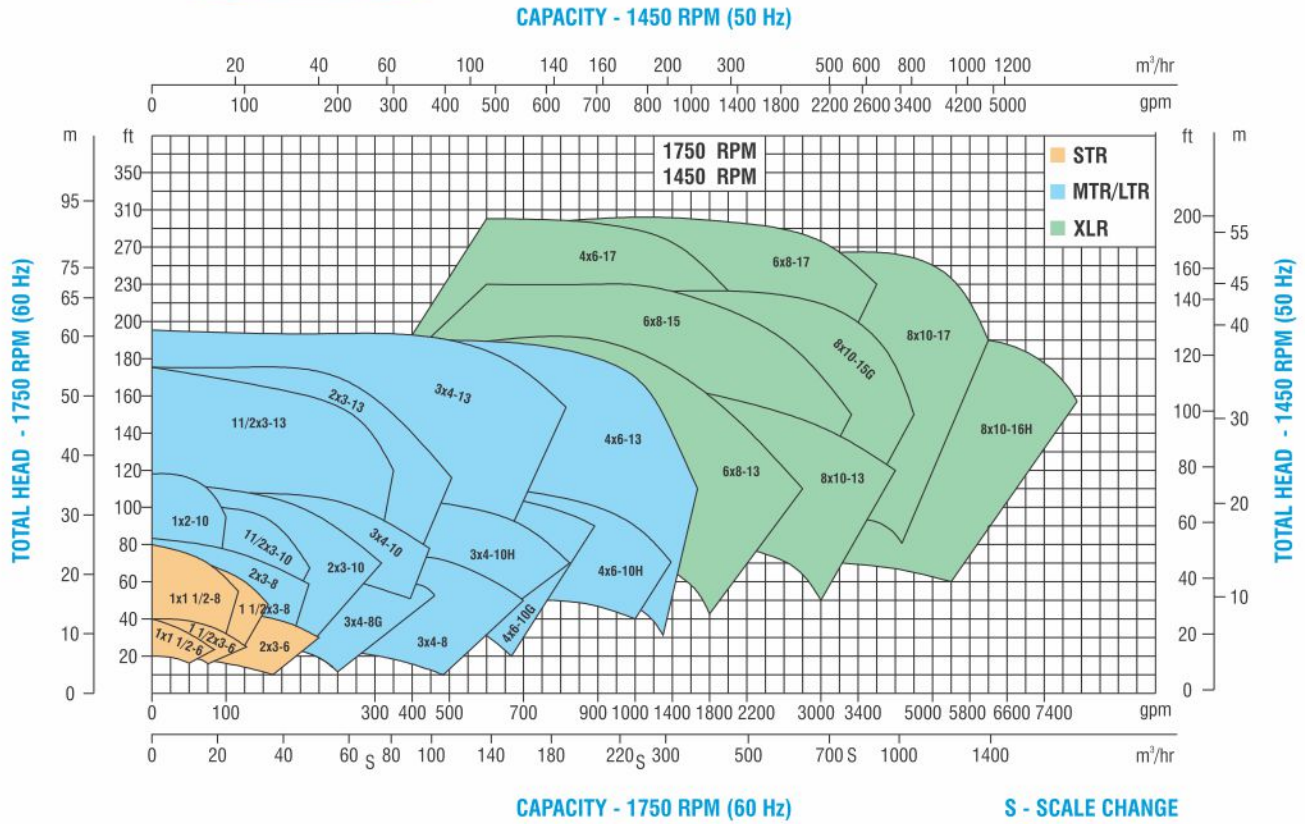

DIMENSIONS

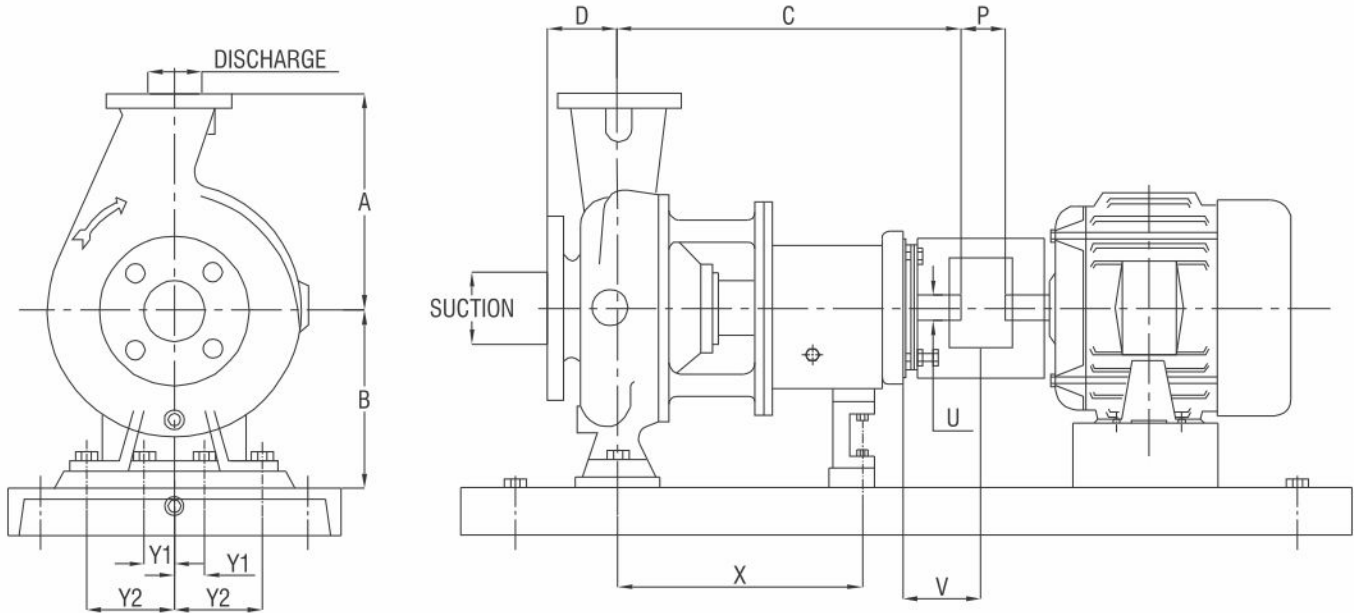

Pump Frame	Pump Size	ANSI Designation	Discharge Size	Suction Size	A	B	C	D	Y1	Y2	X	H	P	U	V	Bare Pump Weight LBS.											
STR	1x1.5-6	AA	1	1.5	6.5 (165)	5.25 (133)	13.5 (343)	4 (102)	0	3 (76)	7.25 (184)	5/8 (16)	3.75 (95)	0.875 (22)	2 (50)	85											
	1.5x3-6	AB	1.5	3												94											
	2x3-6		2	3												96											
	1x1.5-8	AA	1	1.5												102											
	1.5x3-8	AB	1.5	3												110											
MTR	3x4-7	A70	3	4	11 (280)	8.25 (210)	19.5 (495)	4 (102)	3.625 (92)	4.875 (124)	12.5 (318)	5/8 (16)	3.75 (95)	1.125 (28.5) MTR	2.625 (67)	222											
	2x3-8	A60	2	3	9.5 (242)											222											
	3x4-8	A70	3	4	11 (280)											222											
	3x4-8G	A70	3	4	11 (280)											222											
	1x2-10	A05	1	2	8.5 (216)											204											
	1.5x3-10	A50	1.5	3	9.5 (242)											222											
	2x3-10	A60	2	3	9.5 (242)											232											
	OR	3x4-10	A70	3	4											11 (280)	10 (254)	19.5 (495)	4 (102)	3.625 (92)	4.875 (124)	12.5 (318)	5/8 (16)	3.75 (95)	OR	2.625 (67)	266
		3x4-10H	A40	3	4											12.5 (318)											276
	LTR	4x6-10	A80	4	6											13.5 (343)	10 (254)	19.5 (495)	4 (102)	3.625 (92)	4.875 (124)	12.5 (318)	5/8 (16)	3.75 (95)	1.875 (47.6) LTR	2.625 (67)	308
4x6-10G		A80	4	6	248																						
4x6-10H		A80	4	6	278																						
1.5x3-13		A20	1.5	3	10.5 (267)	334																					
2x3-13		A30	2	3	11.5 (292)	410																					
3x4-13		A40	3	4	12.5 (318)	410																					
XLR	4x6-13	A80	4	6	13.5 (343)	14.5 (368)	27.875 (708)	6 (152)	4.5 (114)	8 (203)	18.75 (476)	7/8 (22)	5.25 (135)	2.375 (60)	4 (100)	560											
	6x8-13	A90	6	8	16 (406)											670											
	8x10-13	A100	8	10	18 (457)											610											
	6x8-15	A110	6	8	18 (457)											740											
	8x10-15	A120	8	10	19 (483)											710											
	8x10-15G	A120	8	10	19 (483)											850											
	8x10-15H	A120	8	10	19 (483)											650											
	4x6-17		4	6	16 (406)											730											
	6x8-17		6	8	18 (457)											830											
	8x10-17		8	10	19 (483)											830											

* XLR series pump are under development, please contact us for update

ROTECH'S OTHER PRODUCTS

- ▶ DNJ Series End Suction Close Coupled Pumps
- ▶ DN Series End Suction Frame Mounted Pumps
- ▶ 1196LF series Low Flow ANSI Pumps
- ▶ 1296 Series ANSI Close Coupled Pumps
- ▶ 1796 Series ANSI Self Priming Pumps
- ▶ RCP Series End Suction Pumps
- ▶ RST Series Stainless Stamped End Suction Pumps
- ▶ RVMS Series Vertical Multistage Centrifugal Pumps
- ▶ RVI80 Series Vertical Inline Pumps
- ▶ SPT/SPU Series Self Priming Trash Pumps
- ▶ SCP/SFP Series Self Priming Pumps
- ▶ S100 Series Sanitary Centrifugal Pumps
- ▶ L100 Series Lobe Pumps
- ▶ RDSL Series Horizontal Multistage Centrifugal Pumps
- ▶ 3100 Series NPT & 5100 Series Flanged Ball Check Valves
- ▶ Various Mechanical Seals

Apart from the listed above,
we offer an array of other products too.
Contact us for further details.



"A Trusted Partner in Pump Solutions"

1320 Britannia Road East
Mississauga, Ontario, Canada. L4W 1C8

Phone: (905) 461-9617 | Fax: (905) 461-9618
Toll Free: 1-866-217-PUMP (7867)
Email: sales@rotechpumps.com | www.rotechpumps.com